

INSTALLATION INSTRUCTIONS

05+ NISSAN FRONTIER/XTERRA 2WD/4WD U.C.A.A.

Driver side only:

The factory steering shaft interferes with the removal of this bolt. Disconnecting the steering shaft is necessary in order to remove the factory control arm. If the bolt becomes damaged, recommends purchasing the factory bolt from Nissan.

Important Note:

Once the factory upper control arm is removed, there are two raised contact points in each pivot on the frame. These must be ground or sanded off before installation of arm.

You may have to grind the hat of the bushings to fit/clearance into the factory pocket.

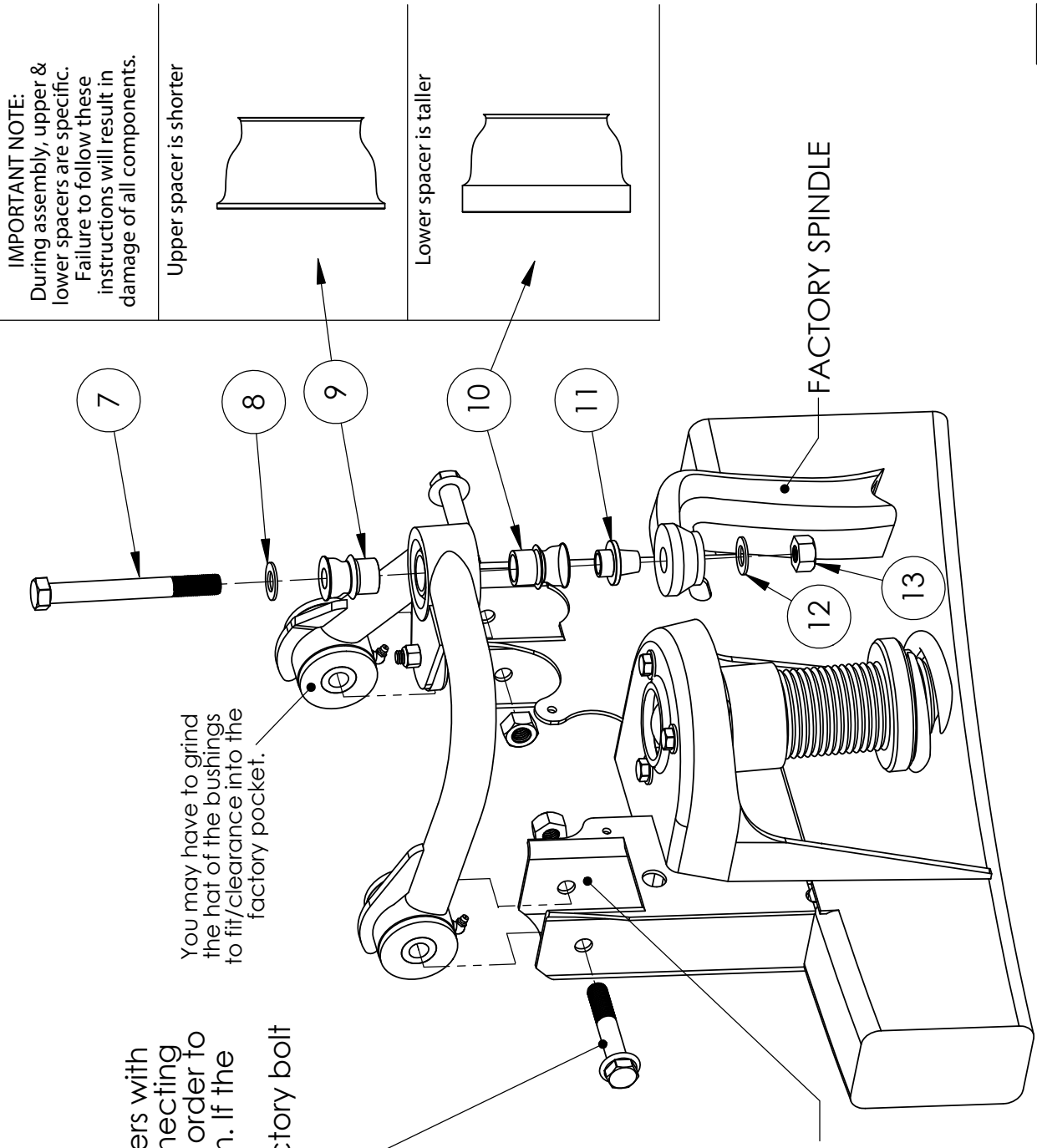

*LEFT SIDE OF TRUCK SHOWN. SOME ITEMS NOT SHOWN FOR CLARITY.

On some vehicles it may be necessary to trim the upper strut tower to allow clearance for the ball joint. To check, pull down the control arm to check if the ball joint can pass the upper strut tower. If not grind the upper strut tower to allow for the arm / ball joint to pass the tower. See Photo 11.

